

Etatron Standard Pump Head 1-15lph

Standard Pump Head 1-15l/hr with manual prime/bleed

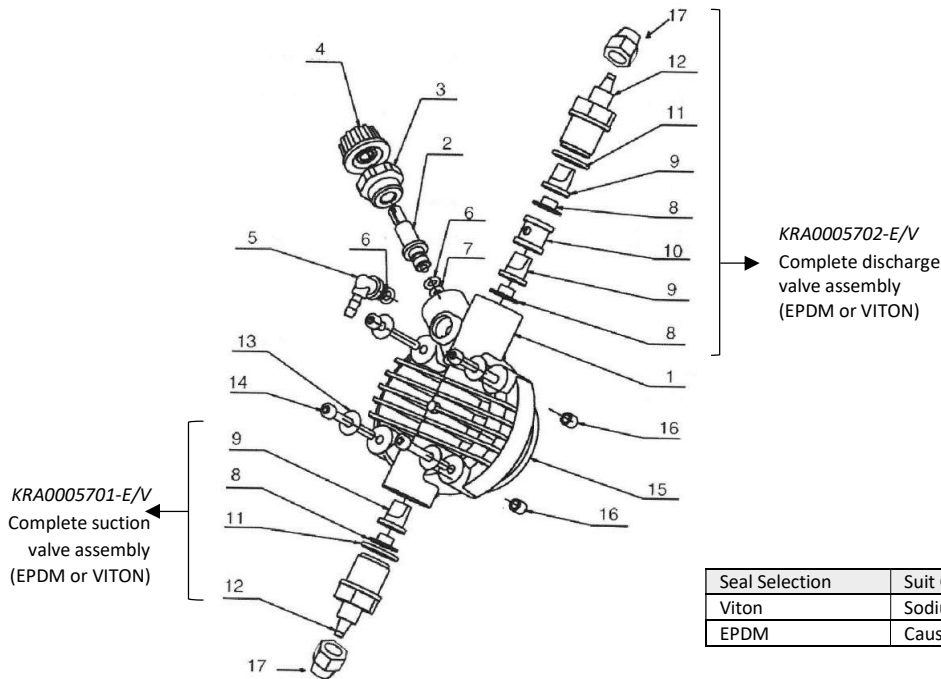

Complete Pump Head
SCP0003002 (Viton)
SCP0003006 (EPDM)

Seal Selection	Suit Chemicals
Viton	Sodium Hypo, Acids
EPDM	Caustics

	Description (Australian Part Numbers)	Order code	Qty
1	Standard bare pump head for air bleed, PP, 2-15lph	DCP0000801	1
2	Air bleed screw	DVI0005401	1
3	Air bleed cap	DTP0005001	1
4	Air bleed knob	DMA0005001	1
5	Air bleed nipple	DRA0005101	1
6	O-ring, 2018 Viton	4042.052	2
7	O-ring, 2012 Viton	4042.105	1
8 + 9	Lip valve-Viton (up to 20lph), includes lip valve guide	14D-Viton	3
8 + 9	Lip valve-EPDM (up to 20lph), includes lip valve guide	14D-EPDM	3
10	Air bleed spacer	DDI0005301	1
11	O-ring, 2062 Viton	4042039	2
12	Pump head nipple (PP)	4031006	2
13	4mm washer	DRO0010801	4
14	4 x 35 Stainless socket screws	DV10006002	4
15	O-ring 3200 pump head, Viton	4042031	1
16	Pump head bush	4042.002	4
17	Tube nut	4031002	2
18	Complete pump head (PP), manual bleed, 1-15lph VITON	ETA SCP0003002	1
18	Complete pump head (PP), manual bleed, 1-15lph EPDM	ETA SCP0003006	1
18	Complete pump head (PP), 1-15lph VITON, suits old style DL series	ETA-DL-14	1
19	Pump head service kit (items 8, 11, 12, 14, 15, 17), foot valve assembly 2142001, injection valve 2144009	KCP0000701	1
	Inlet valve complete assembly (EPDM)	KRA0005701-E	1
	Inlet valve complete assembly (VITON)	KRA0005701-V	1
	Outlet valve complete assembly (EPDM)	KRA0005702-E	1
	Outlet valve complete assembly (VITON)	KRA0005702-V	1
	Diaphragm to suit PKX and DLX series pumps (PTFE)	4084-001	1
	Mounting bracket for PKX series pumps (dual position)	DSA00000601	1

Etatron Standard Pump Head 1-15lph

Replacement injection valves and filter assemblies to suit the Etatron PKX and DLX series dosing pumps are available according to pump type and capacity

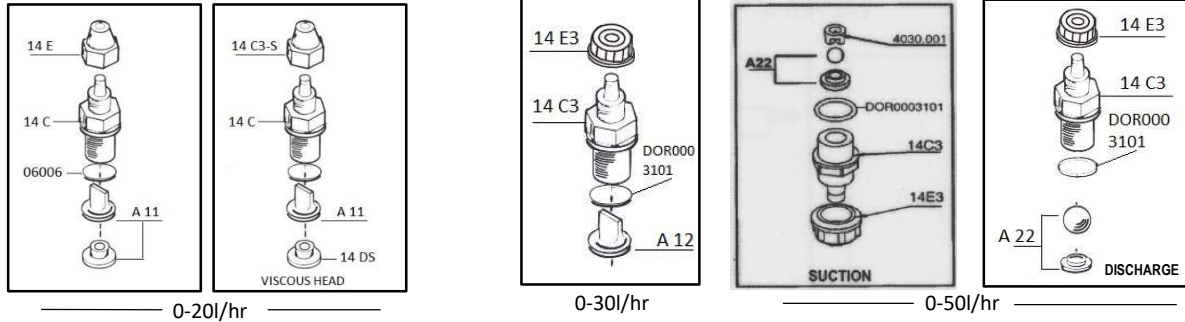

Injection Lip Valve Type	Part	Description
A11 Style Lip Valve, 1-20lph	A11-14D-Viton	A11 Viton lip valve
	A11-14D-EPDM	A11 EPDM lip valve
	A11-14D-Silicon	A11 Silicon lip valve
A12 Style Lip Valve, 30-80lph	A12-39-Viton	A12 Viton lip valve
	A12-39-EPDM	A12 EPDM lip valve
	A12-39-Silicon	A12 Silicon lip valve
A22 Style Ball Valve, gravity, 50-80lph	A22-2144.043	PVC/Stainless Steel
	A22-39-EPDM	PVC/Pyrex

Injection Valve up to 20l/hr

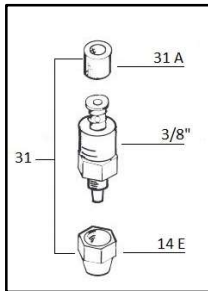

Injection Valve 30-80l/hr

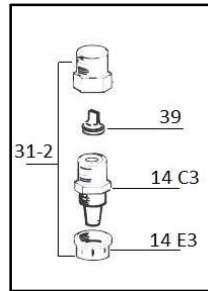

Filter >20l/hr

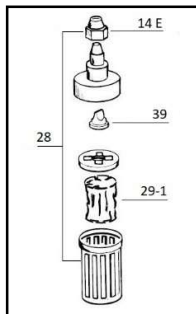

Filter >30l/hr

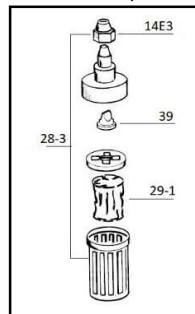

Part Number	Description
ETA 2144009	Injection valve 1-20lph VITON (#31)
ETA 2144015	Injection valve 1-20lph EPDM (#31)
ETA 31-A	Sleeve-VITON 1-20lph (#31A)
ETA 31-EPDM	Sleeve-EPDM 1-20lph (#31A)
ETA 31-2	Injection valve VITON 30-80lph (#31-2)
ETA 4144022	Lip valve VITON 30-80lph (#39)
ETA 4144014	Lip valve EPDM 30-80lph (#39)
ETA 4031002	Tube nut 1-20lph (#14E)
ETA DGH0006101	Tube nut 30-80lph (#14E3)
ETA 4031006	Nipple 6x4 (#14C)
ETA 4031020	Nipple 14x10 viscous head (##14E3)
Part Number	Description
ETA 2142001	Foot filter VITON (#28)
ETA 2142004	Foot filter EPDM (#28)
ETA 29-1	Filter wool (PP) (#29-1)
ETA 28-3	Foot filter 30-80lph (#28-3)